

Reptile Basics, Inc
VE CB 70-5 Series 2
Assembly Instructions

Order CB 70 tubs from:
Iris USA Model # CB 70
<http://www.shopirisusa.com/clear-box-with-buckles-37-qt-cb-70-clear>

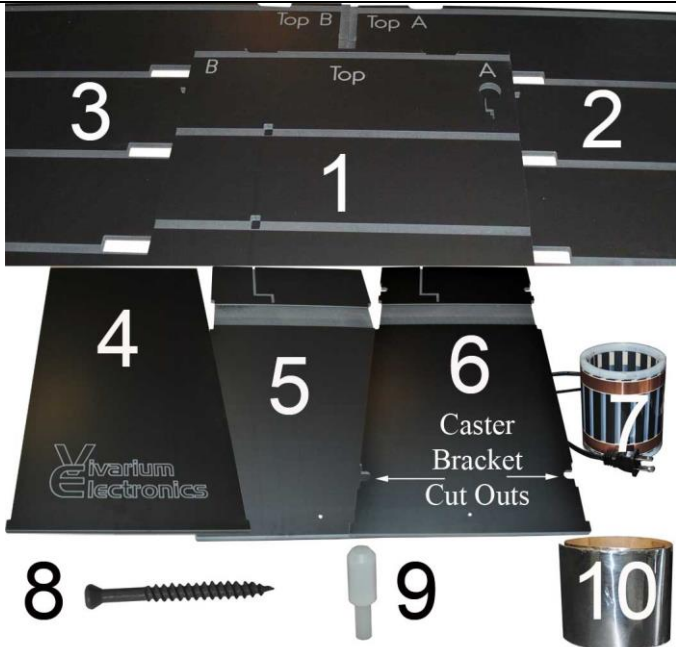

- Parts List:
1. Back - Marked "B Top A"
 2. Right Side - Marked "A Top"
 3. Left Side - Marked "B Top"
 4. Top Shelf- Has no slot for probe or Heat Tape
 5. Shelves- These have a probe groove and a slotted cutout for the heat tape.
 6. Bottom Shelf- Has slotted cutout for heat tape and cut outs for caster brackets (Caster set sold separately)
 7. Heat Tape with Power Cord
 8. Screw 60
 9. White Locking Pins 5
 10. Aluminum Tape

1. Identify the parts listed above and lay them out. Set the Top Panel aside. It will be the last piece to be installed.

2. Locate the back panel (A Top B) (1) and the Right panel (A Top)(2) and align using arrows and alignment tabs and slots. (Fig. 11&12) Note that the Text will be on the inside of the rack and not visible once assembly is complete. Make sure each tab is fully aligned in the Slot, then drive screws in through the pre drilled holes.(Fig. 13,14) *Do Not Over Tighten* Screw Head should be flush with outer surface when fully tightened. It will be self Recessing.

3. Locate the Left panel (B Top) and align again using arrows and Tab/Slot. Secure with screws. (Fig. 15)

5. Slide the Bottom shelf panel into bottom slot. (Part # 6)Make sure that the heat tape slot faces toward the top of the rack and that it slides fully into the slot in the back panel. The front of the shelf should be flush with the front edge of the side panels.(Fig. 16) Pull the shelf forward slightly if needed. Install a screw through each predrilled hole in sides A and B, being careful not to over tighten and you are ready to install the next shelf.

6. At this point you can continue assembly with the rack on it's back, installing each shelf

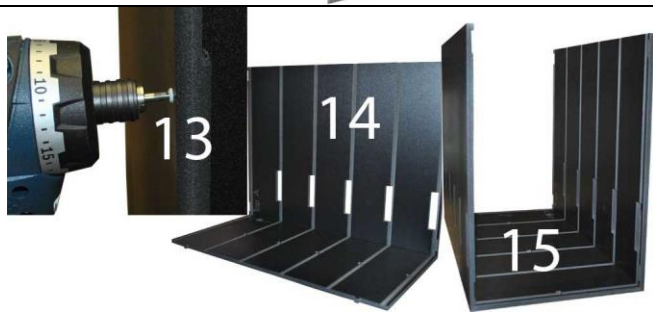
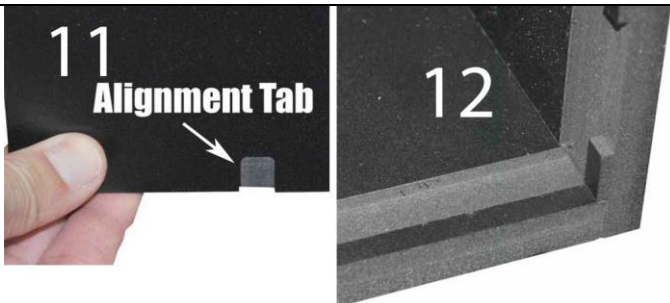

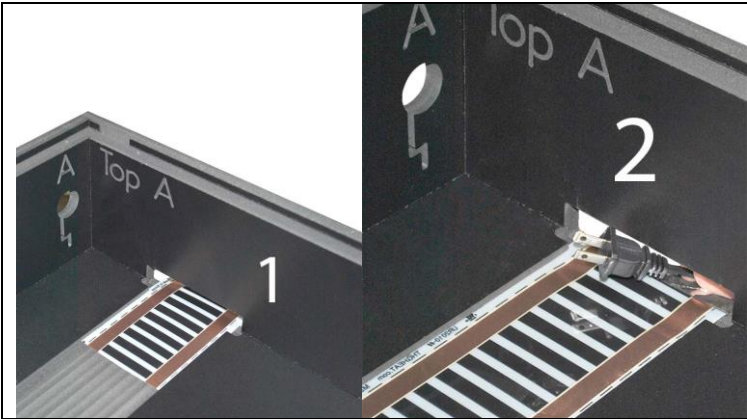

the same as the first, then stand it upright.(Fig.17) Do not install top at this time.

7. Once this is complete, you can install your heat tape. Install the heat tape by sliding the end of the heat tape (without the power cord) inward through the opening nearest "Top A" guiding the edges into the slots on each side of the recess and under the skids that were installed earlier stopping once the power cord is almost into the opening. At this point put the power cord plug through the same opening as the heat tape and feed the power cord through. (Fig. 2) Feed the power cord out through the back of the rack(Fig. 3), slide the cord down into the slot, placing the strain relief (zip tie) against the rack back.(Fig. 4) Then work the heat tape into the position shown, (Fig. 4) the tape into place using 4-6inches of aluminum tape. (Fig. 5)

Next feed the free end of the heat tape back onto the same slot that it exits, down through the opening between the shelf and side and out through the opening on the level below.(Fig 6) Holding the heat tape at as shown, (fig 7) pull out the excess until completely inside the Rack. Repeat this for each shelf.

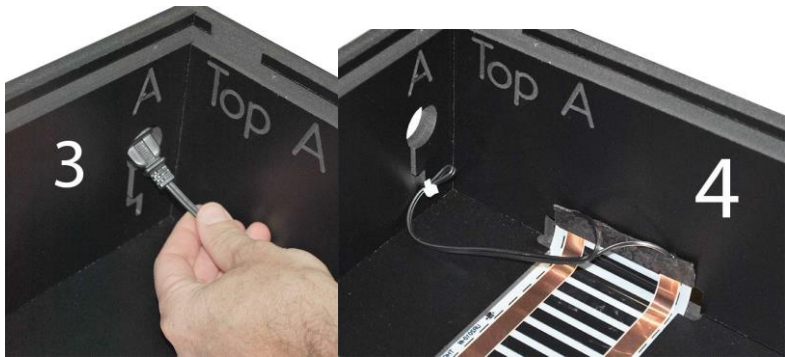

8. Probe placement: We recommend installing the thermostat probe on a center shelf as close as possible to heat tape. You may need to adjust up or down a shelf to suit your needs. Cover the probe wire (not probe tip) with 2" piece of aluminum tape. Do not cover probe tip. (Fig. 9) IMPORTANT: On back of rack use a 4" piece of aluminum tape to secure the probe cord as a strain relief.(Fig. 10)



9. Install the top by sliding into place and fastening with screws, the same as the shelves. (Fig. 11) While you have your screw gun in hand, now is a good time to put the screws in the back of the rack.

White pins are used as shown to prevent tubs from accidentally moving forward.(Fig12)

